



### Level 14/Unit 1407/22 Market Street Sydney NSW

- \* Impressive, Inspirational top floor location
- \* Stunning views of Darling Harbour
- \* Excellent natural light
- \* Wide windows and large frontage
- \* LED lights throughout
- \* Prominent commercial building with 3 lifts
- \* Contemporary foyers with impressive finishes
- \* Convenient location in major growth precinct
- \* Minutes to Town Hall, QVB and Barangaroo
- \* Close to Cockle Bay, Hyde Park and Haymarket
- \* Quality opportunity - Do not miss out!

Deals like this don't come around too often and this will go quickly, so contact me without delay to coordinate an inspection.

Doran Commercial

**Building Size** : 166.6 sqm  
**View** : <https://www.dorancommercial.com.au/lease/nsw/sydney-city/sydney/commercial/offices/5883317>



**Doran Commercial**  
**02 9953 3400**

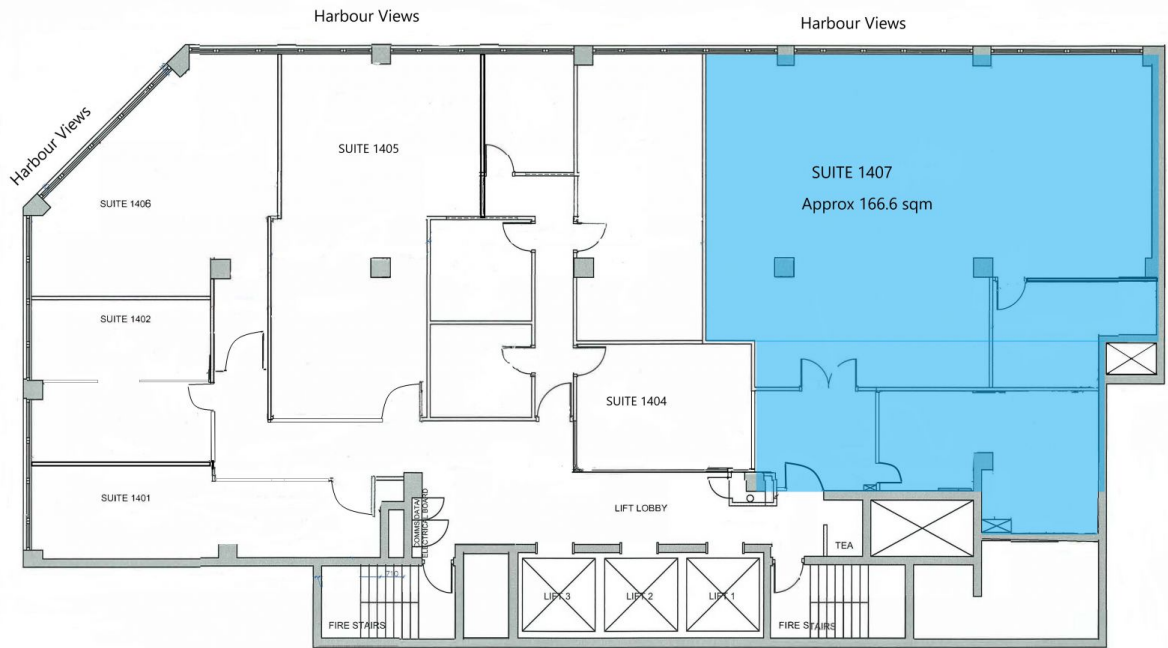

Project Name: L14 22 MARKET ST  
Project Address: L14 22 MARKET ST SYD  
Client: L14 22 MARKET ST SYD  
Drawing Title: EXISTING LAYOUT  
Drawing Number: 01

Project Title: L14 22 MARKET ST  
Project Address: L14 22 MARKET ST SYD  
Client: L14 22 MARKET ST SYD  
Drawing Title: EXISTING LAYOUT  
Drawing Number: 01

Project Title: L14 22 MARKET ST  
Project Address: L14 22 MARKET ST SYD  
Client: L14 22 MARKET ST SYD  
Drawing Title: EXISTING LAYOUT  
Drawing Number: 01

Project Title: L14 22 MARKET ST  
Project Address: L14 22 MARKET ST SYD  
Client: L14 22 MARKET ST SYD  
Drawing Title: EXISTING LAYOUT  
Drawing Number: 01